

"TREE HOUSES"
 ...rentable space, located in the forest, used by companies for the needs of piloting new projects
 ...the "tree-houses" are easily assembled and disassembled, according to the needs of the renting company



HEVOSSAARI HOUSING AREA
 ...is designed to bring nature more closer to people and the city; therefore, this area has strong ecological aspect and is after for LEED certification (excellence in energy and environmental design)



LIGHT CHURCH
 ...is at the end of the Chain and works as the landmark of the city; it's a translucent glass structure, a contemporary interpretation of a light-house



VARSASAARI
 ...is a public island for the citizens of neighboring areas to do sports and different kind of indoor and outdoor activities



OFFICE FRONT
 ...wider row of offices in South-West forms a wall that functions as noise-barrier and separates the housing from the industrial area



MARINE CENTER
 ...serves as a hotel for sailors and tourists who come to Oulu by sea; it contains restaurants, shops and leisure time facilities



SONNISAARI
 ...is a modern building with a unique geometric form

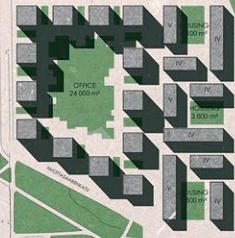

ARTS & CRAFTS CENTER
 ...in the heart of Holihaika park, a center of art exhibitions and ateliers for craftsmen has been situated, creating a new cultural focal point of the city



HOLIHAIKA PARK
 ARTS & CRAFTS CENTER 4,000 m²



KIKELI

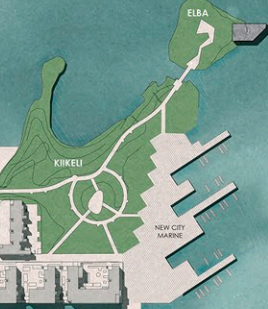

EIBA



VÄNMANNINSAARI
 ...area is filled with buildings of mixed use, it shifts the center of gravity towards the sea and acts as the living room of the citizens and the place for leisure